



📍 15 Bowles Court Westmead Lane, Chippenham, Wiltshire, SN15 3GU

🔗 Offers In The Region Of £115,000

A generous first floor, one bedroom apartment, which forms part of the highly regarded Bowles Court assisted living development, overlooking the River Avon in the centre of Chippenham town centre. Offered with No Onward Chain.

- Generous One Bedroom Apartment
- Spacious Wet-Room
- Walk-in Wardrobe
- Excellent Range of Facilities
- Underfloor Heating & Triple Glazing
- Highly Regarded Assisted Living Development
- Town Centre Location
- No Onward Chain
- Extra Incentive

🏠 Leasehold

🏠 EPC Rating C



Offered with NO ONWARD CHAIN and as an extra INCENTIVE our vendor's would be happy to pay the first 6 months service charge.

An extremely well-located, and well-proportioned one bedroom first floor retirement apartment, situated within the popular Bowles Court development, only a stones throw from Chippenham Town Centre. Bowles Court, overlooking the River Avon and within easy access to the town centre of Chippenham, is purposely built designed exclusively for the over 70's in mind allowing you to continue living independently but with flexible personalised 24 hour domestic or support packages provided by the Your life Team. The accommodation comprises entrance hall, storage cupboard, wet room, large double bedroom with walk-in wardrobe, lounge / diner and modern integrated kitchen.

Bowles Court has a variety of communal facilities such as:-

- A table service restaurant offering a three-course menu that changes daily,
- A homeowner's lounge,
- Wheelchair and scooter storage,
- 1 hour free domestic support,
- On-site car parking for permit holders,
- Viewing deck overlooking the River Avon,
- A laundry room and laundry service available
- A lift that accesses all floors
- An excellent guest suite widely used by visiting family and friends for which a charge of £25 per night applies.

Offered with NO ONWARD CHAIN and as an extra INCENTIVE our vendor's would be happy to pay the first 6 months service charge.

Situation

About 200 metres from the centre of town, Bowles Court is an ideal spot. It is close to a variety of local supermarkets- the closest being Waitrose and a vibrant shopping high street with retail stores, banks, chemists, independent shops and regular street markets. Chippenham has a Community Hospital, a number of GP Surgeries, is located close to junction 17 of the M4 and has excellent train and bus services with direct services to London, Bath, Swindon or Bristol. Places of interest in the local area are varied with John Coles Park, the Museum, the Heritage Centre and Chippenham Folk Festival just a few examples. It also retains some impressive railway arches and architectural triumphs built by the famous engineer Brunel. As an ancient riverside market town, Chippenham also has plenty of historical intrigue for those interested in living in this area. Natural attractions are also found in abundance with the River Avon, the Cotswolds, Salisbury Plain and Birds Marsh (a large marshland of around 24 hectares or 29 acres) just a few places in the area you might like to visit.

Property Information

Council Tax Band; C

Leasehold

Mains Services

Underfloor Heating & Triple Glazing

EPC Rating; C

NO ONWARD CHAIN



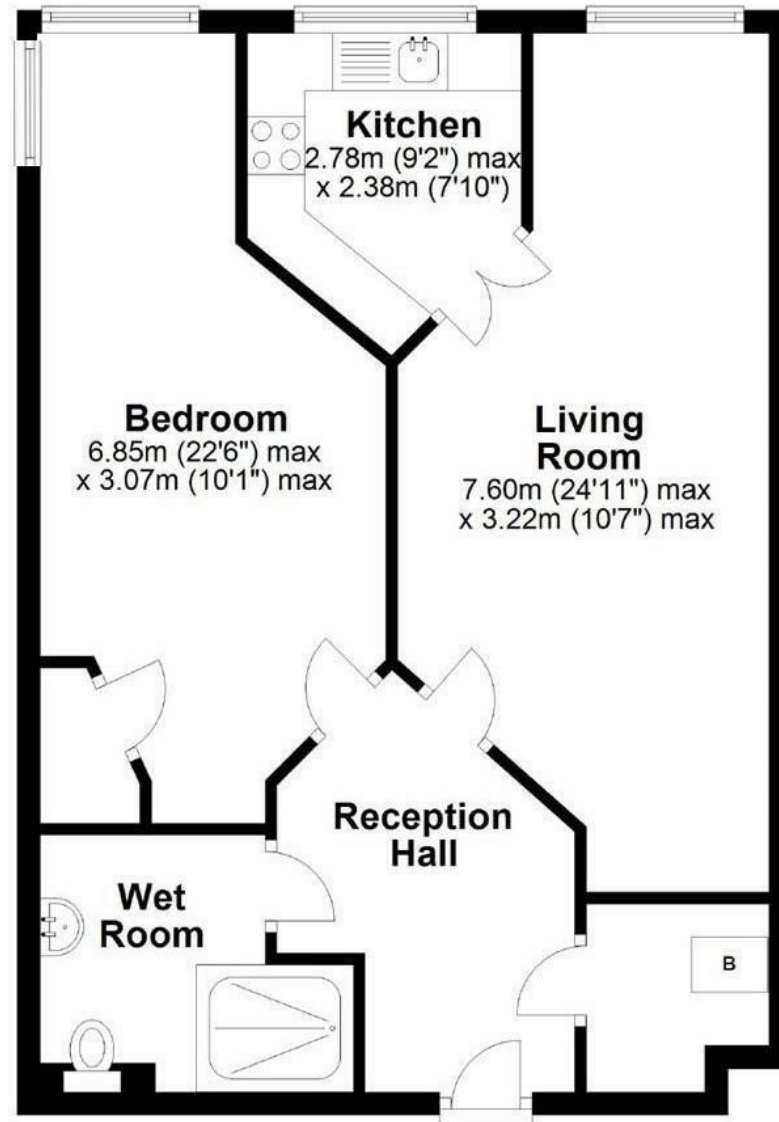

Disclaimer These particulars, whilst believed to be accurate are set out as a general outline only for guidance and do not constitute any part of an offer or contract. Intending purchasers should not rely on them as statements of representation of fact, but must satisfy themselves by inspection or otherwise as to their accuracy. No person in this firm's employment has the authority to make or give any representation or warranty in respect of the property. All measurements and distances are approximate only. Your home is at risk if you do not keep up repayments on a mortgage or other loan secured on it.